

Booking Terms & Conditions

Effective from 1 July 2010. GST included. Prices and information subject to change without notice.

- Credit card details are required to secure all bookings.
- Persons under 18 will not be accepted as a guest in the park without a parent present.
- 1 car only per site.
- Only ground sheets made of shade cloth or open weave material are permitted.
- No pets permitted in park.

Booking Periods

- Peak Season – 24/12/10-30/1/11, Easter and October Long Weekend inclusive.
- Weekend – 2pm Friday to 2pm Sunday, when available. 2 night minimum applies.
- Standard Season – All other times
- Sites/Cabins are booked from 2pm (Check in) on day of arrival until 10am (check out) on day of departure unless otherwise stated or arranged.
- Minimum bookings may apply.

Deposits

- Credit Card deposits are required at time of booking.
- Peak Season bookings – 50% of total booking.
- Standard and Shoulder Season bookings – One night's accommodation.

Cancellation and Refunds

- Deposits are non-refundable within 1 month of arrival.
- No refunds for early departures.
- Cancellation Fee of \$50.00 applies to all bookings.
- Failure to arrive (no show) will incur the full charge against the clients credit card.

Additional Fees and Charges

- Site Extra Fees – \$10 per night applies to extra persons 5 years and over, boats, extra vehicles and trailers.
- Late Departure Fees – \$20 subject to availability.
- Cleaning Fee – \$200 may apply if cabin/site left in poor condition.

local attractions and activities

- Bushland setting
- Absolute frontage to Boatharbour Beach foreshore – safe for children
- Direct access to famous Inyadda Beach – a mecca for surfers
- Bushwalking – or just drift along the lovely beaches
- Beach and rock fishing
- Resident wildlife, parrots and kangaroos
- Volleyball court
- Half court basketball
- Safe playgrounds for children
- BBQ huts and camp kitchen
- Our friendly on-site park managers are available to assist and make your stay an enjoyable and memorable one
- Jumping pillow
- Sorry, no pets allowed

bendalong point



price list

1 July 10 – 30 June 11



Contact our Managers – **Brent & Julie Huckel**
Red Point Road Bendalong NSW 2539
Toll Free **1300 733 025** Tel / Fax 02 4456 1167
Email bendalong@shoalhaven.nsw.gov.au
Web www.holidayhaven.com.au/bendalong





bendalong point

Standard \$
(2 person)

Peak \$
(flat rate)

I N C L U S I O N S

(prices include GST)

	Per Night	Weekend	Per Week	Per Night	Per Week	Extras (standard season 2 adult)	Extras (standard season 1 child)	No of Cabins	TV	DVD	Air Conditioning	Ceiling Fan	Microwave Oven	Spa	Ensuite Bathroom	Queen Bed	Double Bed	Single Bed	Double Bunks	Triple Bunks	Linen (main bed only)	Towels/Hand Towels	BBQ	Sleeps
Holiday Cottage	360	720	2160	440	3080	0	0	1	•	•	•	•	•	•	2	•	•	4	•	•	•	•	•	12
Waratah	210	440	1260	290	2030	20	10	1	2	•	•	•	•	•	•	•	•	1	•	•	•	•	•	5
Gables Ocean	200	420	1200	270	1890	20	10	7	•	•	•	•	•	•	•	•	•	2	•	•	•	•	•	5/6
Gables Bush	180	380	1080	255	1785	20	10	5	•	•	•	2	•	•	•	•	•	•	•	•	•	•	•	5/6
Sandpiper	150	320	900	215	1505	20	10	10	•	•	8	•	•	•	•	•	•	•	•	•	•	•	•	5
Shoalhaven	130	280	780	180	1260	20	10	5	•	•	•	•	•	•	•	•	•	•	•	•	•	•	•	5

Ensuite Sites

2 Person	55	330	65	455	10
Pensioner	50	300	65	455	10

Powered Sites

2 Person	40	240	45	315	10
Pensioner	35	210	45	315	10

Unpowered Sites

2 Persons	30	180	35	245	10
Pensioners	25	150	35	245	10

All rates based on 2-person rate

Waratah (Cabin 199)

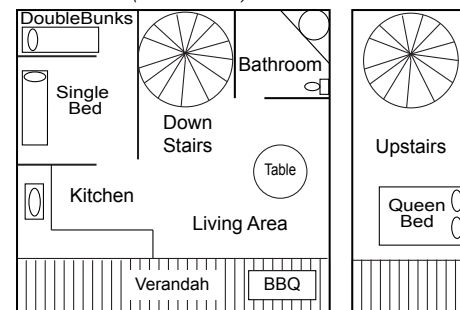

Gables Bush (Cabins 39, 40, 178, 179, 180)

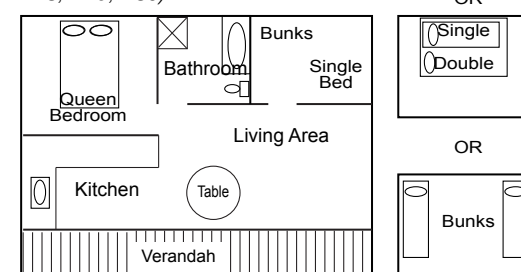

Gables Ocean (Cabins 81, 82, 83, 84, 197, 198 & 200)

Shoalhaven (Cabins 1, 2, 3, 4 & 5)

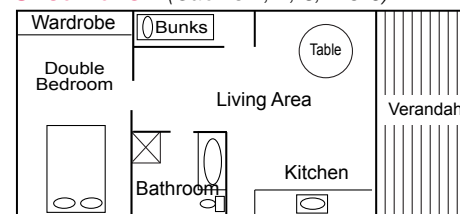

Sandpiper (Cabins 35-38, 193-196, 201 & 202)

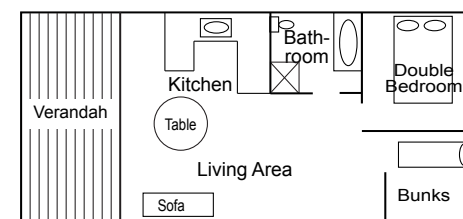

Cabin plans are a guide only. There may be some variations.