

## Booking Terms & Conditions

**Effective from 1 July 2010. GST included.**  
**Prices and information subject to change without notice.**

- Credit card details are required to secure all bookings.
- Maximum 4 adults per cabin.
- Peak season – minimum charge 2 adults per site
- Persons under 18 will not be accepted as a guest in the park without a parent present.
- 1 car only per site.
- Only groundsheets made of shade cloth or open weave material are permitted.
- No pets permitted in the park.

### Booking Periods

- Peak season – 17 December 2010 to end of summer school holidays. Minimum bookings apply
- Easter and October long weekend – Minimum bookings apply
- Standard season – Minimum bookings may apply
- Sites/cabins are booked from 2pm (Check in) on day of arrival until 10am (check out) on day of departure.

### Deposits

- Credit card deposits are required at time of booking.
- **Bookings** – 50% deposit required for bookings of 7 nights or more
- Full payment required for bookings less than 7 nights
- Christmas holiday bookings – 50% on booking with balance payable by 30 September 2010.

### Cancellation and Refunds

- Deposits are non-refundable within 1 month of arrival.
- No refunds for early departures.
- Cancellation fee of \$100 applies to all bookings.
- Failure to arrive (no show) will incur full payment.

### Additional Fees and Charges

- Linen hire – \$20 per person.
- Day visitor – \$10 per person.
- Extra vehicles – \$10 per vehicle per night.
- Cleaning fee – up to \$200 of cabin left in unsatisfactory condition.

HH003 05/10

## local attractions and activities

- Direct access to beautiful Culburra Beach
- Covered BBQs
- Adjacent to regional boat ramps with direct access to the ocean and the famous Banks fishing grounds
- Walk to Crookhaven Headland – see the majestic Shoalhaven River enter the sea
- Two full-size tennis courts adjacent
- Majestic views to the mountains across the Shoalhaven Bight
- Playground for children
- Direct access to the Shoalhaven River foreshores
- Spacious, shady sites
- Attractive surroundings and grounds
- Resort style pool
- Jumping pillow
- Internet access
- Sorry, no pets allowed

## crookhaven heads



**25-40% off weekly standard rates**

## price list

**1 July 10 – 30 June 11**



Contact our Managers – **Steve & Kathy Pascall**  
Prince Edward Avenue Culburra NSW 2540  
Toll Free **1300 733 026** Tel / Fax 02 4447 2849  
Email [crookhaven@shoalhaven.nsw.gov.au](mailto:crookhaven@shoalhaven.nsw.gov.au)  
Web [www.holidayhaven.com.au/crookhaven](http://www.holidayhaven.com.au/crookhaven)





# crookhaven heads

**Standard \$**  
(2 person)    **Weekly**  
(2 person)    **Peak \$**  
(2 person)

## I N C L U S I O N S

(prices include GST)

	1st Night	Other night	Extras	Shoulder Season	Low Season	Per Night	Per Week	No of Cabins	TV	DVD	Air Conditioning	Ceiling Fan	Microwave Oven	Spa	Bathroom	Queen Bed	Double Bed	Single Bed	Double Bunks	Triple Bunks	Linen (main bed only)	BBQ	Sleeps
<b>Osprey</b>	215	140	25	791	633	265	1855	5	3	•	•	•	•	•	•	•			2	•	•		6
<b>Heron</b>	175	110	25	626	500	225	1575	1	•	•	•	•	•	•	•	•				•	•		2
<b>Sandpiper</b>	175	110	25	626	500	225	1575	2	2	•	•	•	•					2		•	•		6
<b>Shearwater</b>	175	110	25	626	500	225	1575	2	2	•	•	•	•						•	•	•		5
<b>Ibis</b>	175	110	25	626	500	225	1575	1	2	•	•	•	•			2	•			•	•		5
<b>Pelican</b>	175	110	25	626	500	225	1575	1	2	•	•	•	•			•	•			•	•		4
<b>Jabiru</b>	175	110	25	626	500	225	1575	1	•	•	•	•	•					•		•	•		4

**Shoulder Season** – 1 September 2010 to 30 April 2011 ex. Peak times and school holidays. **Low Season** – 1 May to 30 June 2011, 1 July 2010, 31 August 2010

### Powered Ensuite Sites

	per person	2 person		per person	
Per Person	25	262	210	35	245
Children	10			10	70

### Powered Sites

Per Person	19	199	159	25	175
Children	10			10	70

### Unpowered Sites

Per Person	17	178	142	23	161
Children	10			10	70

**Peak Season** All sites min 2 adults per night.

### Pelican (Cabin 12)

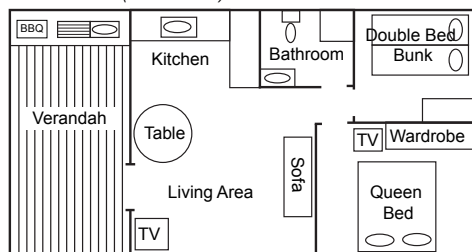

### Ibis (Cabin 9)

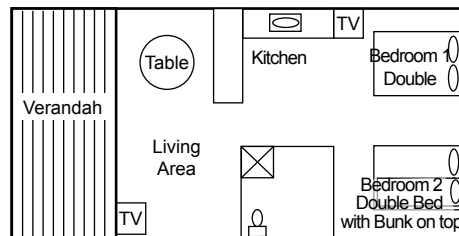

### Osprey (Cabins 4, 5, 6, 7 & 8)

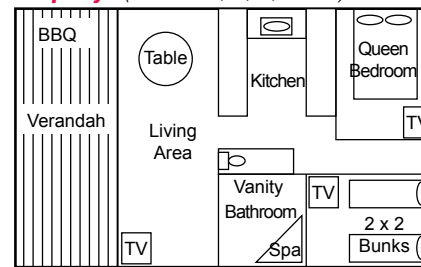

### Heron (Cabin 13)

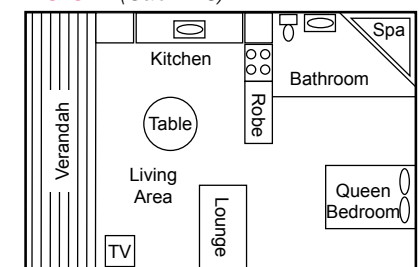

### Sandpiper (Cabins 10 & 11)

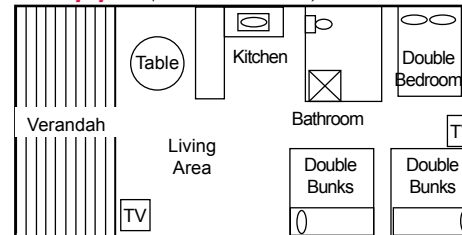

### Shearwater (Cabins 14 & 15)

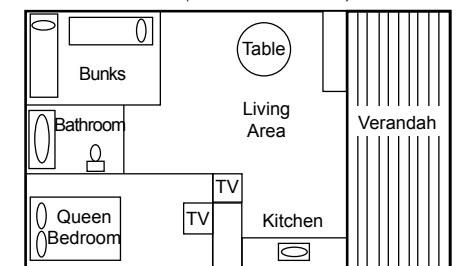

Cabin plans are a guide only. There may be some variations.