

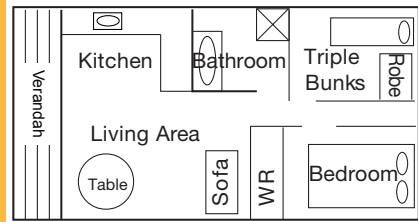

Collingwood (Cabins 9, 10, 11, 12 & 12A)

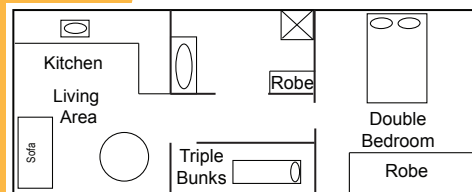

Jervis Bay (Cabins 8, 14, 15, 16, 19, 20, 21, 22, 23, 24, 25, 26, 30 & 31)



Special Access Unit (Cabin 18)

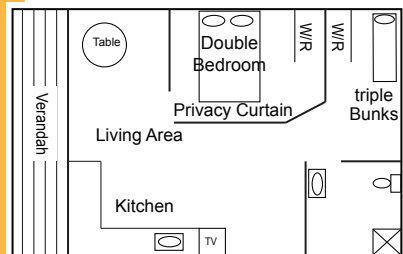

Booking Terms & Conditions

Effective from 1 July 2011. GST included. Prices and information subject to change without notice.

- Credit card details are required to secure all bookings.
- Persons under 18 will not be accepted as a guest in the park without a parent present.
- 1 car only per site.
- Only ground sheets made of shade cloth or open weave material are permitted.
- No pets permitted in park.

Booking Periods

- Peak season – 19/12/11 to 26/12/2011, 9/1/2012 to 27/1/2012, Easter and October Long Weekend inclusive.
- Premium season – 26/12/11–9/1/12
- Standard season – All other times
- Shoulder season – weekends only 1/10/11–31/3/12
- Sites/cabins are booked from 2pm (check in) on day of arrival until 10am (check out) on day of departure unless otherwise stated or arranged.
- Minimum bookings may apply.

Deposits

- Credit card deposits are required at time of booking.
- Peak season bookings – 50%
- Standard and shoulder season bookings – one night's accommodation.

Cancellation and Refunds

- Deposits are non-refundable within 1 month of arrival.
- No refunds for early departures.
- Cancellation fee of \$50 applies to all bookings.
- Failure to arrive (no show) will incur the full charge against the clients credit card.

Additional Fees and Charges

- Extras fees – \$10 per night applies to persons over 5 years, boats, extra vehicles and trailers.
- Late departure fees – \$25 subject to availability.
- Cleaning fee – up to \$200 may be charged if cabin left in unsatisfactory condition.
- Linen hire – \$10 per bed
- Day visitor – \$10 per person.

local attractions and activities

- Absolute frontage to beautiful Jervis Bay
- Walking distance to clubs, hotel, shopping, restaurants and cinema
- Cruise on Jervis Bay – see the dolphins and whales
- The Lady Denman museum is not to be missed
- Full-size tennis court
- Playgrounds for children
- Swimming pool
- Access to lovely white sanded beaches and super foreshore areas
- Austar available in selected cabins
- Sorry, no pets allowed

huskisson beach



price list

1 July 11 – 30 June 12



Please contact our Managers – **John & Kerrie Warren**
 Beach Street Huskisson NSW 2540
 Toll Free **1300 733 027** Tel / Fax 02 4429 5431
 Email huskybeach@shoalhaven.nsw.gov.au
www.holidayhaven.com.au/huskissonbeach
www.huskissonbeachtouristresort.com.au





huskisson beach

Standard \$ (2 person) | **Peak \$** (per cabin) | **Premium \$** | **Shoulder** (per cabin)

I N C L U S I O N S

(prices include GST)

	Per Night	Weekend	Per Week	Per Night	Per Week	Per Night	Per Week	Weekend	Extras	No of Cabins	TV	DVD	Air Conditioning	Ceiling Fan	Microwave Oven	Spa	Bathroom	Queen Bed	Double Bed	Single Bed	Double Bunks	Triple Bunks	Trio Bunks	Linen (main bed only)	Towels/Hand Towels	BBQ	Sleeps
Seaview Deluxe	190	420	1140	310	2170	326	2282	470	10	5	•	•	•	•	•	•	•	•	•	•	•	•	•	•	•	•	5
Seaview	185	410	1110	305	2135	321	2247	460	10	5	•	•	•	•	•	•	•	•	•	•	•	•	•	•	•	•	5
Beachcomber	185	410	1110	305	2135	321	2247	460	10	6	•	•	•	•	•	•	•	•	•	•	•	•	•	•	•	•	6
Reef	185	410	1110	305	2135	321	2247	460	10	5	•	•	•	•	•	•	•	•	•	•	•	•	•	•	•	•	5
Ocean	185	410	1110	305	2135	321	2247	460	10	3	•	•	•	•	•	•	•	•	•	•	•	•	•	•	•	•	5
Lagoon	185	410	1110	305	2135	321	2247	460	10	2	•	•	•	•	•	•	•	•	•	•	•	•	•	•	•	•	5
Paradise	185	410	1110	305	2135	321	2247	460	10	4	•	•	•	•	•	•	•	•	•	•	•	•	•	•	•	•	6
Bayview	150*	340	900	270	1890	284	1988	370	10	3	•	•	•	•	•	•	•	•	•	•	•	•	•	•	•	•	5
Collingwood	125*	290	750	230	1610	242	1694	310	10	6	•	•	•	•	•	•	•	•	•	•	•	•	•	•	•	•	5
Jervis Bay	95*	230	570	180	1260	189	1323	240	10	14	•	•	•	•	•	•	•	•	•	•	•	•	•	•	•	•	5

*Surcharge for one night stays

Paradise (Cabins 43-46)

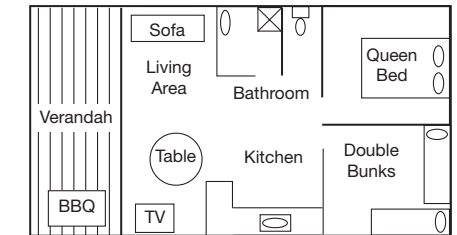

Ocean (Cabins 47, 49, 51)

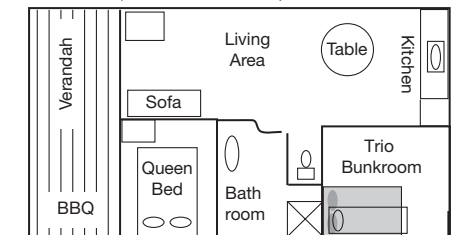

Powered Sites

Standard (2 Person)	38	76	228	65	455
Pensioners	30	60	180	65	455

Unpowered Sites

Standard (2 Person)	30	60	180	50	350
Pensioners	28	56	168	50	350

Powered Ensuite Sites

Standard (2 Person)	54	108	324	86	602
Pensioners	50	100	300	86	602

Seaview Deluxe (Cabins 6, 7, 27, 28 & 29)

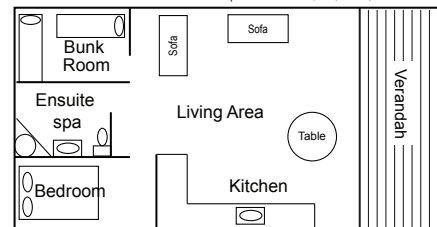

10
10

Seaview (Cabins 1-5)



10
10

Beachcomber (Cabins 35-40)

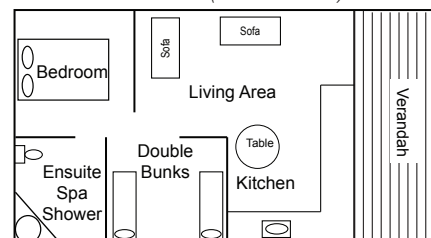

10
10

Bayview (Cabins 17, 41 & 42)

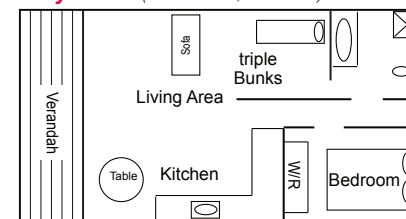

Lagoon (Cabins 48 & 50)

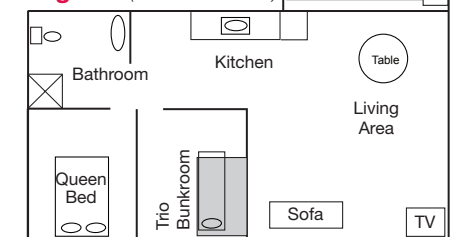

Reef (Cabins 52-56)

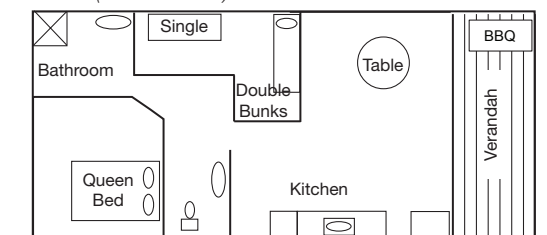

Cabin plans are a guide only. There may be some variations.