

Booking Terms and Conditions

Effective from 1 July 2010. GST incl.

- Prices and information subject to change without notice.
- Credit card details are required to secure all bookings.
- Maximum 4 adults per cabin and per site. No smoking in any cabin.
- Persons under 18 will not be accepted as a guest in the park without a parent present.
- 1 car per site only.
- Only groundsheets made of shade cloth or open weave material are permitted.
- No pets permitted in the park.

Booking Periods

- Peak Season – December to end of Summer School holidays. Easter and October Long weekend exclusive.
- Standard Season – All other times.
- Weekend Packages – Minimum 2 nights, 3pm checkout Sunday – excludes peak periods.
- Sites/cabins are booked from 2pm (check in) on day of arrival until 10am (check out) on day of departure unless otherwise stated or arranged.
- Additional day stay/late checkout must be booked and paid for on check in. Conditions Apply.
- Minimum bookings may apply during certain booking periods.

Deposits

- Credit Card deposits are required at time of booking.
- Peak Season bookings – 50% deposit.
- Standard Season bookings – One night's accommodation.

Cancellation and Refunds

- Deposits are non-refundable within 1 month of arrival.
- No refunds for early departures.
- Failure to arrive (no show) will incur the full charge against the clients credit card.

Additional Fees and Charges

- Late departure fees may apply.
- Cleaning fee will be charged if cabin left in poor condition.
- Bond required for group park bookings.
- Day visitor - \$10 per person. Must be booked in advance.

HH001 05/10

local attractions and activities

- Bushland setting
- Park shop
- Half basketball court, volley ball grassed court
- River access
- Playground
- Covered BBQ area
- Picnic facilities throughout park
- Short walk to local shops and restaurants
- DVDs free to cabins
- On-site managers
- Designated camp sites for couples and families
- Close to Pioneer Farm Museum
- Adjacent to the historic Hampden Bridge
- River beach
- Canoe, kayak and bikes available for hire
- Horse riding – adults and children catered for
- Bushwalking through rainforests and national park
- Winery
- 5 minutes to the golf course
- Local tennis courts available for hire
- Short drive to Fitzroy, Carrington and Belmore Falls
- Sorry, no pets allowed



Contact our Managers – **Michael & Susan Boden**
Moss Vale Road Kangaroo Valley NSW 2577
Toll Free **1300 559 977** Tel / Fax 02 4465 1310
Email KVALLEY@shoalhaven.nsw.gov.au
Web www.holidayhaven.com.au/kangaroovalley

kangaroo valley



Kangaroo Valley's own Boutique Park

price list

1 July 10 – 30 June 11





kangaroo valley

Standard \$

Peak \$

I N C L U S I O N S

(prices include GST)

	Per Night (Sun-Thur)	Weekend package (2 nights)	Weekend (1 night Fri or Sat)	Weekend Saturday Special	Per Week (7 days)	Per Night (Sun-Thur)	Weekend (2 nights)	Per Week (7 days)	No of Cabins	Sleeps	Max. Adults per cabin	Linen (main bed only)	Towels	Bathroom	Air Conditioning	TV / DVD	BBQ	Microwave Oven	Queen Bed	Double Bed	Double Bunks	Triple Bunks
Bunk Room (20, 21, 22) Per person	35	N/A	35	N/A	N/A	45	45	NA	3	2	2	•							•			
Bungalow – Kitchen (10)	80	230	130	150	440	100	230	600	1	2	2	•	•	•	•			•	•			
Bungalow (18, 19)	70	210	120	140	N/A	90	220	NA	2	2	2	•	•	•	•			•	•			
Carrington (1, 2, 7)	90	270	150	170	495	120	280	760	3	2	2	•	•	•	•			•	•			
Carrington Deluxe (5, 6)	110	290	160	180	605	140	300	860	2	2	2	•	•	•	•			•	•			
Shoalhaven (3, 4)	120	320	170	190	660	160	330	970	2	5*	2	•	•	•	•			•	•			•
Shoalhaven Deluxe (12)	130	340	180	200	715	170	360	1020	1	5*	4	•	•	•	•	•		•	•			•
Yarrunga (11)	130	340	180	200	715	170	360	1020	1	5*	4	•	•	•	•	•		•	•			•
Wattamolla (15, 16)	140	360	N/A	N/A	770	200	410	1200	2	4*	4	•	•	•	•	•		•	•			
Cambewarra Deluxe (8, 9)	140	360	N/A	N/A	770	200	410	1200	2	5*	4	•	•	•	•	•		•	•			•
Barrengarry (17)	150	380	N/A	N/A	825	215	435	1295	1	6*	4	•	•	•	•	•		•	•			1

Powered Sites

Maximum 4 adults per site

Per Person	14	35	N/A	N/A	98	18	40	126
------------	----	----	-----	-----	----	----	----	-----

Minimum 2 night stay for Caravans and RVs on weekends

Unpowered Sites

Per Person	12	30	N/A	N/A	84	17	38	119
------------	----	----	-----	-----	----	----	----	-----

*Maximum 4 adults per cabin

CHECK-OUT TIMES

Sun to Thurs nights – 10am Check-out

Weekend 2 nights – 3pm Check-out

Weekend 1 night – 10am Check-out

Weekend Saturday **Special** – 3pm Check-out

All Peak Season bookings – 10am Check-out

Carrington (Cabins 1, 2, 7)

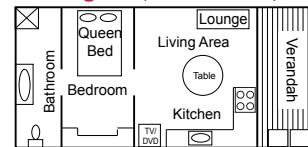

Shoalhaven (Cabins 3, 4)

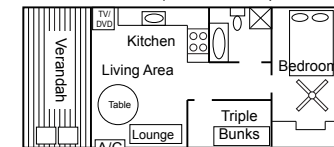

Cambewarra-Deluxe (8, 9)

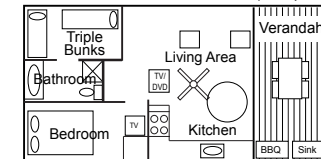

Wattamolla (Cabins 15, 16)

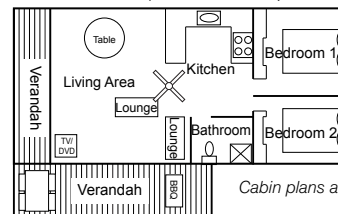

Yarrunga (Cabin 11)



Barrengarry (Cabin 17)

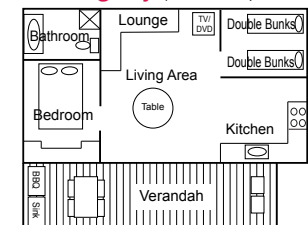

Cabin plans are a guide only. There may be some variations.